

For models: 120GA / 120GB / 120S /
240GA / 240GB / 240D / 240S / 277S / 347S

1 Introduction

The PB112 power base is designed to power a TH11x Series control module.
Refer to the technical specifications for maximum resistive load.

2 Installation Guidelines

Turn off power to the heating system at the main power panel to avoid electrical shock. Installation should be carried out by an electrician.

- ▶ High voltage thermostats must be installed onto an electrical box.
- ▶ For a new installation, choose a location about 5 ft. above the floor.
- ▶ The thermostat must be installed facing the heating system.
- ▶ The thermostat must be installed on an inside wall.
- ▶ Avoid locations where there are air drafts (top of staircase, air outlet), dead air spots (behind a door), direct sunlight or concealed chimneys or stove pipes.

Figure 1

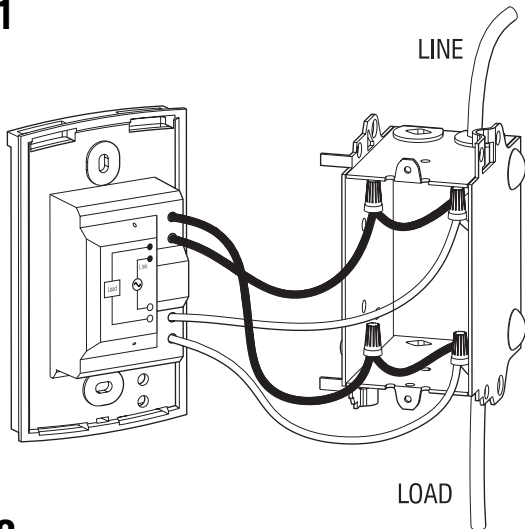
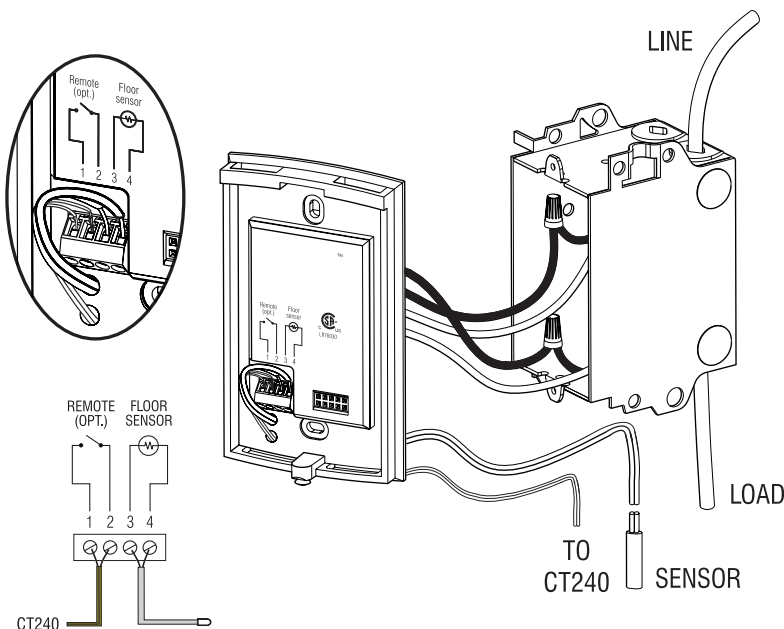
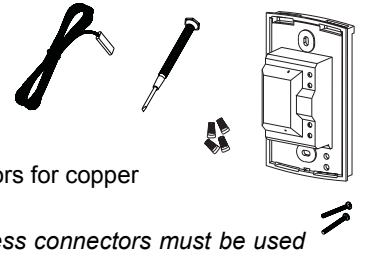

Figure 2



3 Material

- 1 One (1) power base
- 2 Two (2) screws
- 3 Four (4) solderless connectors for copper wires



NOTE: Special CO/ALR solderless connectors must be used when connecting with aluminum conductors.

- 4 One (1) floor sensor and one (1) flat tip screwdriver (for GA and GB models only)

4 Installation Steps

- 1 Connect the rear thermostat wires (FIGURE 1) to the power and to the load using solderless connectors for copper wires.

Connecting the floor sensor (Figure 2)

- Insert the probe into one of the two holes available below the terminal board and connect the wires to terminals 3 and 4 (no polarity needs to be respected).
- The cable must run on the left side of the cavity located on top of the terminal board, **outside** the electrical box and follow the wall down to the floor.
The temperature sensor wire cannot cross any heater wires and must NOT be directly on or adjacent to a heating wire. For maximum performance, the sensor probe should be centered between the wires in the mat.

Connecting the remote input (Figure 2)

- Insert the remote cable (use an 18 to 22 gauge flexible wirecable) into one of the two holes available below the terminal board and connect CT240 terminals 1 and 2 to PB112 terminals 1 and 2 respectively.
 - The cable must run on the left side of the cavity located on top of the terminal board and **outside** the electrical box.
- 2 Push the excess wire (except for the probe/remote) back into the electrical box to prevent interference with the thermostat.
 - 3 Secure the thermostat using two (2) screws. Once the thermostat is properly installed, return power to heating system.

Technical Specifications

Model	Supply	Max. Load	Power	Conn. ^a	GFCI
120GA	120 VAC, 60Hz	15 A	1800 W	4w/DP	5 mA
120GB	120 VAC, 60Hz	15 A	1800 W	4w/DP	30 mA
120S	120 VAC, 60Hz	20 A	2400 W	4w/SP	
240D	240 VAC, 60Hz	15 A	3600 W	4w/DP	
240GA	240 VAC, 60Hz	15 A	3600 W	4w/DP	5 mA
240GB	240 VAC, 60Hz	15 A	3600 W	4w/DP	30 mA
240S	240 VAC, 60Hz	20 A	4800 W	4w/SP	
277S	277 VAC, 60Hz	15 A	4155 W	4w/SP	
347S	347 VAC, 60Hz	15 A	5205 W	4w/SP	

a. Connection type: 4w = 4 wires, DP = Double Pole, SP = Single Pole

Storage: -4°F to 120°F (-20°C to 50°C)

GFCI: GA = 5 mA, GB = 30 mA trip level

Remote input: Dry contact

Size (H • W • D): 124 x 70 x 23 mm (4.89 x 2.76 x 0.91 in)

Certifications:



Models:
120 GA / GB
240 GA / GB



Models:
120S / 240S
240D / 277 / 347S

AUBE TECHNOLOGIES INC. ONE (1) YEAR LIMITED WARRANTY

This product is guaranteed against workmanship defects for a one year period following the initial date of purchase. During this period, AUBE Technologies Inc. will repair or replace, at our option and without charge, any defective product which has been used under normal conditions. The warranty does not cover delivery costs and does not apply to products poorly installed or randomly damaged following installation. This warranty cancels and replaces any other manufacturer's express or implied warranty as well as any other company commitment. AUBE Technologies Inc. cannot be held liable for related or random damages following the installation of this product. The defective product as well as the purchase invoice must be returned to the place of purchase or mailed, prepaid and insured, to the following address:

Aube Technologies Inc.
705 Montrichard
Saint-Jean-sur-Richelieu, Quebec, Canada J2X 5K8

If you have any questions concerning the installation of the PB112 power base, call our technical support team at:

Phone: Montreal area: (450) 358-4600
Canada / U.S.: 1-800-831-AUBE (2823)

Fax: (450) 358-4650

Email: service@aubetech.com

Monday to Friday from 8:30 AM to 5:00 PM EST.

For more information on our products, visit us at:

www.aubetech.com